

BERKSHIRE™ ASHLAR - 3H  
 FULL-BED VENEER - 3 5/8" THICK  
 INDIANA LIMESTONE - FULL COLOR BLEND™

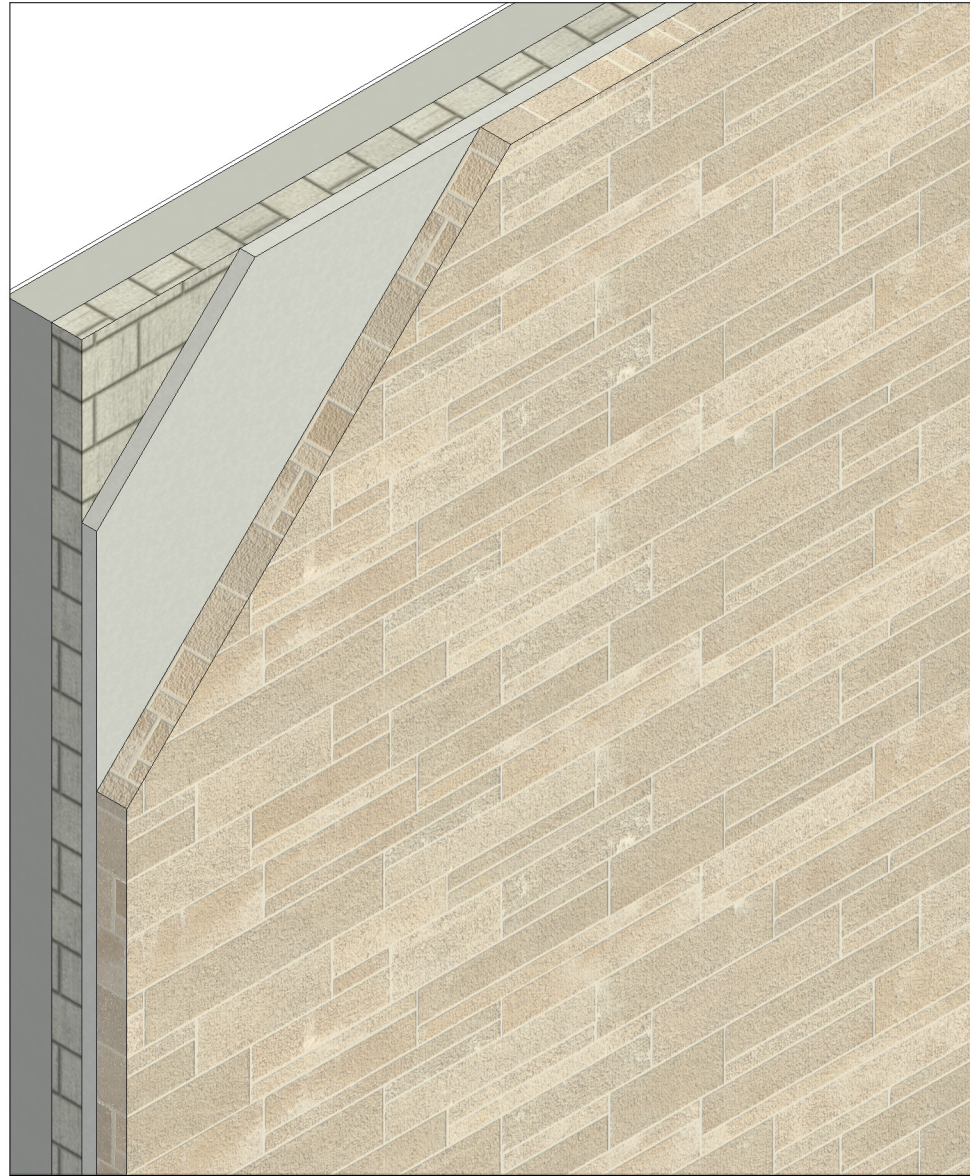

(WALL SYSTEM SHOWN FOR REFERENCE)



(DIMENSIONS PROVIDED FOR REFERENCE)

Berkshire™ is a solid, split-face veneer. Variations in height create a classic, pleasant, and seemingly random definition for commercial and fine residential structures.  
 Available in Thin veneer - 1" thick and Full-Bed veneer - 3 5/8" thick. Pallet of mixed sizes available. L-shaped corner pieces are available for Thin veneer.

BERKSHIRE™ ASHLAR - 3H  
 THIN VENEER - 1" THICK  
 INDIANA LIMESTONE - FULL COLOR BLEND™

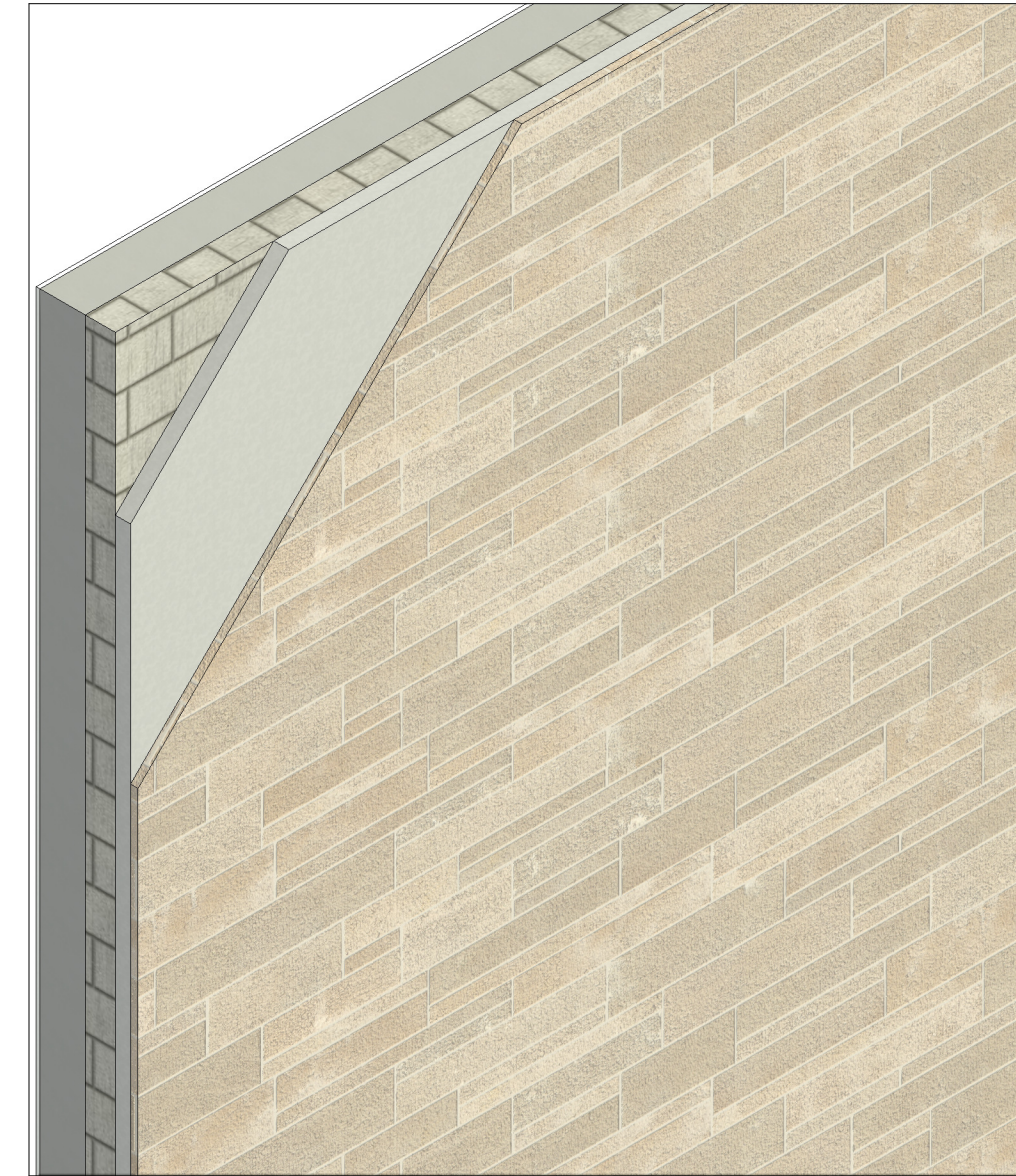

(WALL SYSTEM SHOWN FOR REFERENCE)



(DIMENSIONS PROVIDED FOR REFERENCE)

**REVIT MODEL NOTES:**

Polycor's stone veneer products are represented as a Revit material and applied to the exterior face (layer) of a standard Wall System Family. Actual structure of the Wall System will vary based on architectural and structural requirements of the building design.

